



**Part Number MET0000449**

1000 LTR 3 PLY, 2 x 60mu LLDPE (inner and intermediate) 1 x 60mu EVOH (outer). 1% Blue Tint  
 Fill gland: 1" Aseptic Fill with 900mm x 350mm trunk  
 Discharge: 2" Butterfly Valve DN50 thread (square) c/w cap, oring and folding handle.

Metano is a **BRC grade A** approved manufacturer, certified to BRC Global Standard for Packaging and Packaging Materials (High Hygiene) Issue 4. The products are produced in a validated ISO8 clean room.

**Description**

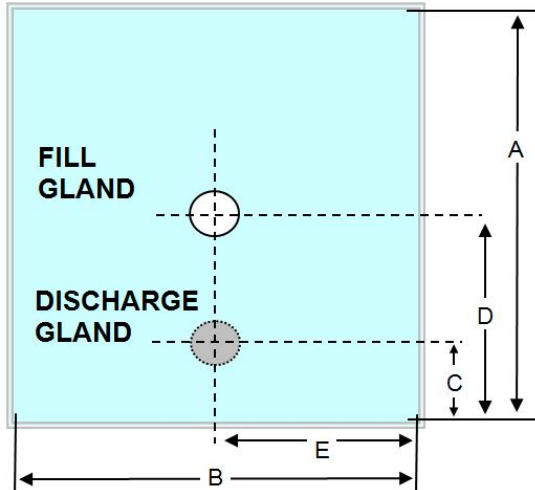

|                  |                             |
|------------------|-----------------------------|
| Volume           | 500Ltr                      |
| Ply              | 3                           |
| Inner            | 1 x 2200mm LLDPE            |
| Inner Micron     | 60mu +/- 10%                |
| Outer            | 1 x 2200mm EVOH             |
| Outer Micron     | 60mu +/- 10%                |
| Int              | 1 x 2200mm LLDPE            |
| Int Micron       | 60mu +/- 10%                |
| Dimension A      | 3600                        |
| Dimension B      | 2140                        |
| Dimension C      | 630                         |
| Dimension D      | 3500 (100MM FROM TRUNK TOP) |
| Dimension E      | Centre Line                 |
| Destruction Test | 1 in 100                    |
| Gland Weld Width | 8mm                         |
| Liner Weld Width | 8mm                         |



**Metano Limited.** Units 14/15 Winfield Industrial Estate  
Rowlands Gill, Tyne & Wear, United Kingdom. NE39 1EH  
T: +44 (0) 01207 549 448 F: +44 (0) 01207 549 447  
E: sales@metano.com W: www.metano.com

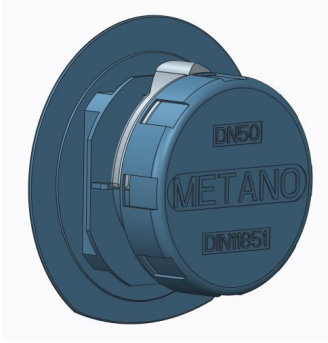

**DN50 Disposable Butterfly Valve LLDPE Blue**

**MET0000441**



**2" Combo Clip.**

**MET0000089**



**1 Inch Aseptic fill gland**

**MET0000413**