



**Part Number MET0000743**

304 Stainless Steel UN approved IBC (1000Ltr).  
 UN approved for packaging Groups 2 & 3.  
 Steam Heating as standard, Low working height, Top lift, Forklift, Pallet truck, Racking.  
 H1140mm x L1150mm x W1150mm  
 1050 litres plus  
 460mm dia manway c/w 2" BSP socket and 2" Pressure and Vacuum valve  
 4 x 2" BSP sockets on the tank top  
 Fully drainable base.  
 Outlet - Full flow, 3 piece, 2" Ball valve with PTFE seals, part F camlock and cap.  
 Manlid Seal PTFE bonded envelope seal.  
 BB steam radiator on the base - 2 Bar steam to give 13.5 Kw of heat or used with water to cool.

**Description**

304 Stainless Steel UN approved IBC (1000Ltr).  
 UN approved for packaging Groups 2 & 3.  
 Steam Heating as standard, Low working height, Top lift, Forklift, Pallet truck, Racking.  
 H1140mm x L1150mm x W1150mm  
 1050 litres plus



<b>Model</b>	Metercube (M3)
<b>Part Number</b>	MET0000743
<b>Capacity</b>	1000
<b>Dimensions External (mm)</b>	H:0 x L:0 x W:0
<b>Dimensions Folded (mm)</b>	H:0 x L:0 x W:0
<b>Tare Kg (from - to)</b>	156 - 180
<b>Gross Weight Kg (from - to)</b>	2756 - 2780
<b>Max S.G</b>	2.6
<b>Base Slope</b>	7 deg
<b>UN Packaging Group</b>	2 3
<b>Test Pressure</b>	0
<b>Max Working Pressure</b>	0.2
<b>Vaccum</b>	0.34
<b>Construction</b>	304 Stainless Steel
<b>Transport and storage</b>	
<b>Warehouse Store</b>	



**Metano Limited.** Units 14/15 Winfield Industrial Estate  
Rowlands Gill, Tyne & Wear, United Kingdom. NE39 1EH  
T: +44 (0) 01207 549 448 F: +44 (0) 01207 549 447  
E: sales@metano.com W: www.metano.com

Stack Qty Full	4
Stack Qty Empty (Folded)	4
<u>40 ft Taut liner</u>	
Stack Qty Full	2
Stack Qty Empty (Folded)	2
<u>Shipping Container</u>	
Stack Qty Full	2
Stack Qty Empty (Folded)	2



**Metercube Swing Bolt Assembly**  
Comprises of  
**MET0000364 Metercube Lid Clamp**  
**MET0000363 Metercube Wingnut Brass**  
**MET0000362 Metercube Eyebolt M12 X 80 A2EB12080**

**MET0000365**



**Metercube Lid Bolt**

**MET0000367**



**2" pre vac**

**MET0001250**



**Drum Cap Stainless steel CLPL00047CLA0001**

**MET0000368**



**M3 PP Camlock Drip Cap (Part DC) 2"**  
Comprises of  
**MET0002583 PP Camlock Drip Cap (Part DC) 2"**

**MET0000369**

**Metercube Spun Manlid 460mm Dia 304 Stainless Steel**

**MET0001936**



**Metercube 2" BSP 2" Male Camlock Part F Stainless Steel**

**MET0000373**

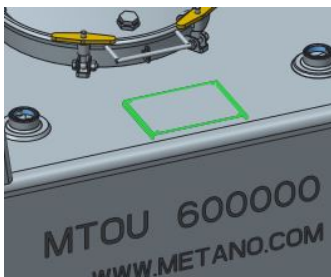

**UN plate for Metercube 743**

**MET0000428**

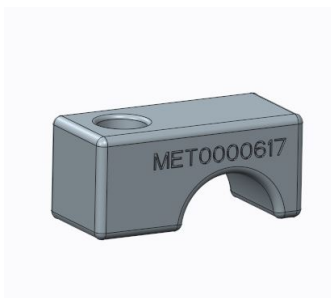

**Universal Metercube Lid Clamp**

**MET0000617**



**2" BSP full flow stainless steel 3 piece ball valve with PTFE seals**

**MET0000492**

**2" RJT hex cap nut**

**MET0002727**



**Metano Limited.** Units 14/15 Winfield Industrial Estate  
Rowlands Gill, Tyne & Wear, United Kingdom. NE39 1EH  
T: +44 (0) 01207 549 448 F: +44 (0) 01207 549 447  
E: sales@metano.com W: www.metano.com

