



Metano Limited. Units 14/15 Winfield Industrial Estate
 Rowlands Gill, Tyne & Wear, United Kingdom. NE39 1EH
 T: +44 (0) 01207 549 448 F: +44 (0) 01207 549 447
 E: sales@metano.com W: www.metano.com

Part Number MET0001452

1000/DN50 x DN50 BV
 1000 LTR Liquid Pillow Liner
 3 PLY 60mu LLDPE film.

Description

1000 LTR FAST FILL Liquid Liner 3 PLY 60mu LLDPE film.
 Fill gland: DN50 with integral seal & cap.
 Discharge: DN50 integral butterfly valve with cap.
 Metano is a **BRC grade A** approved manufacturer, certified to BRC Global Standard for Packaging and Packaging Materials (High Hygiene) Issue 4. The products are produced in a validated ISO8 clean room.

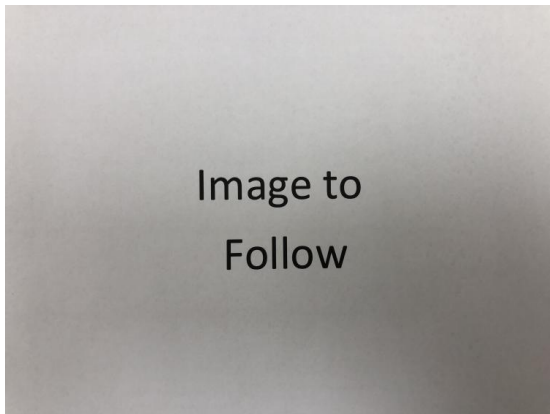

Volume	1000
Ply	3
Inner	1 x 2200 LLDPE
Inner Micron	60mu +/- 10%
Outer	1 x 2200 LLDPE
Outer Micron	60mu +/- 10%
Int	1 x 2200 LLDPE
Int Micron	60mu +/- 10%
Dimension A	2700
Dimension B	2150
Dimension C	500
Dimension D	120
Dimension E	Center Line
Destruction Test	1 in 200
Gland Weld Width	6
Liner Weld Width	8

Applications

1000 Ltr Pillow liners are the most cost effective solution for high volume products such as:

Chemical

Adhesives, automotive lubricants, automotive oils, chemicals, coatings, drilling additives, detergents, inks, paints, polymer emulsions.

Cosmetic

Shower gell, conditioner, cream, lipstick, liquid makeup, lotion, mascara, shampoo, facial scrubs.



Metano Limited. Units 14/15 Winfield Industrial Estate
Rowlands Gill, Tyne & Wear, United Kingdom. NE39 1EH
T: +44 (0) 01207 549 448 F: +44 (0) 01207 549 447
E: sales@metano.com W: www.metano.com

Food & Beverage

Cream, SCM (sweetened condensed milk), fruit juice, edible oils, fish oil, fructose, jams, liquid egg, malts, molasses, pastes, sweeteners, syrups, vinegar, juice, wine, milk.

Pharmaceutical

Manufactured in a validated ISO8 Clean Room



Metano Limited. Units 14/15 Winfield Industrial Estate
Rowlands Gill, Tyne & Wear, United Kingdom. NE39 1EH
T: +44 (0) 01207 549 448 F: +44 (0) 01207 549 447
E: sales@metano.com W: www.metano.com



DN50 Gland Assembly - FILL
Comprises of
MET0000508 DN50 Gland (Blue) manufactured from LLDPE Food safe and FDA material
MET0000485 DN50 DIN11851 Disposable Cap (Blue)
MET0000511 Blue FDA 'O' Ring 54 id x 5mm

MET0000633

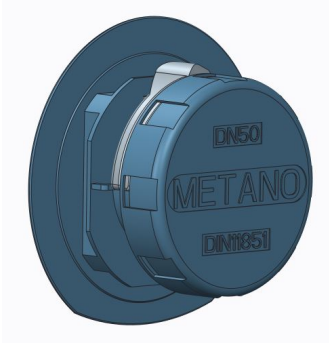

DN50 Disposable Butterfly Valve LLDPE Blue

MET0000441



1% BLUE Tint 60mu LLDPE FILM 2200mm

MET0000379